

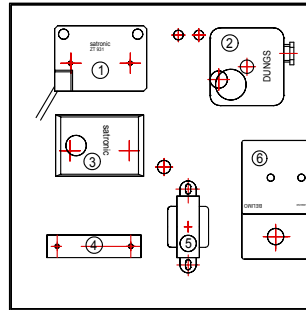

HEATING &
COMBUSTION

VJ 35 AUTOMATIC GAS BURNER UPTO 1025 kW (3,500,000 BTU/hr)

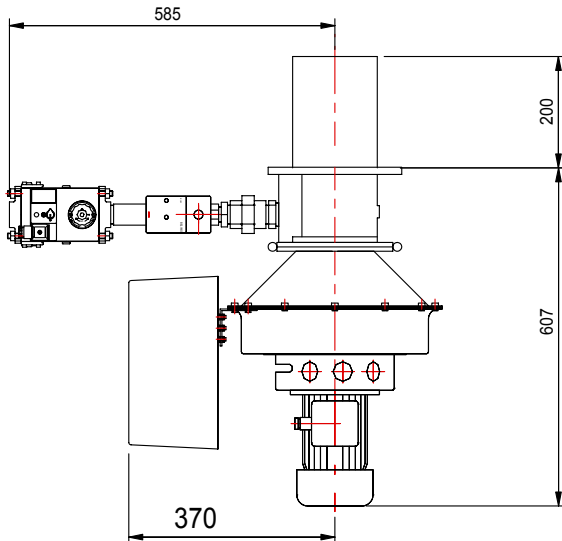

CONTROL PANEL VIEW
WITH COVER REMOVED

- ① IGNITION TRANSFORMER
- ② AIR PRESSURE SWITCH
- ③ BURNER CONTROL BOX
- ④ TYPE B12 TERMINAL BLOCK
- ⑤ VOLTAGE TRANSFORMER
- ⑥ MODULATING MOTOR

4 - M10 TAPPINGS AT 45°
ON CENTRES BETWEEN
190 TO 250 P.C.D.

ALTERNATIVELY
2 - M10 TAPPINGS AT 180°
ON CENTRES BETWEEN
190 TO 220 P.C.D.

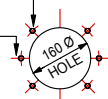

MOUNTING DETAIL

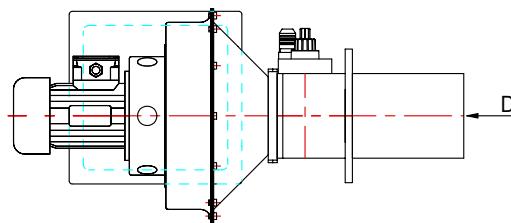
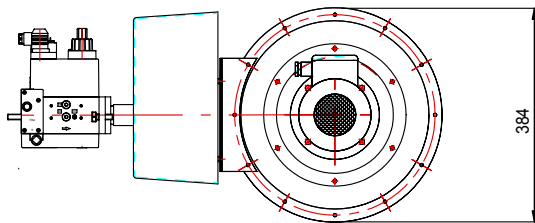

VIEW ON ARROW 'D'

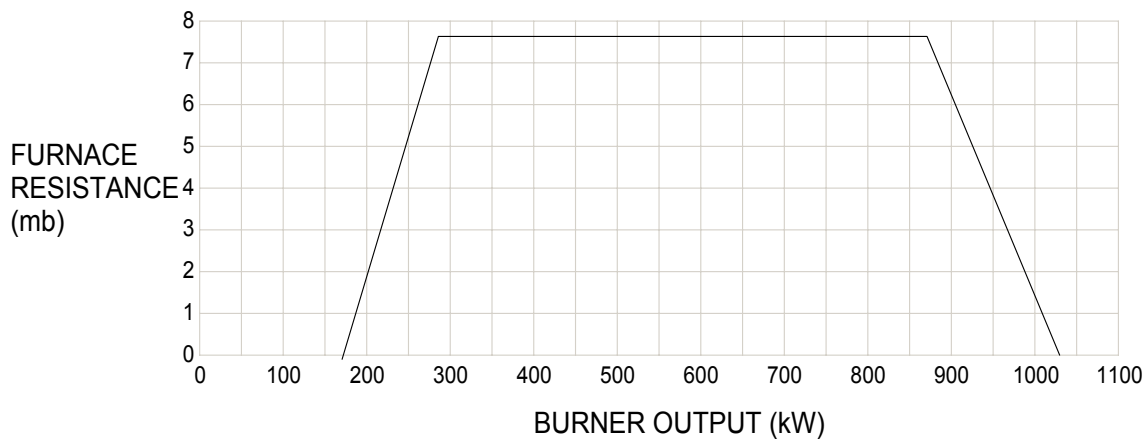

ADVANCED COMBUSTION ENGINEERING LIMITED
UNIT 3 COMMERCE ST.
CARRS IND. EST.
HASLINGDEN
LANCS.
ENGLAND
BB4 5JT

Tel: +44(0)1706212218
Fax: +44(0)1706228735
E-mail: enq@aceburners.co.uk

